

DO NOT SCALE

Millimetres

0 10 100

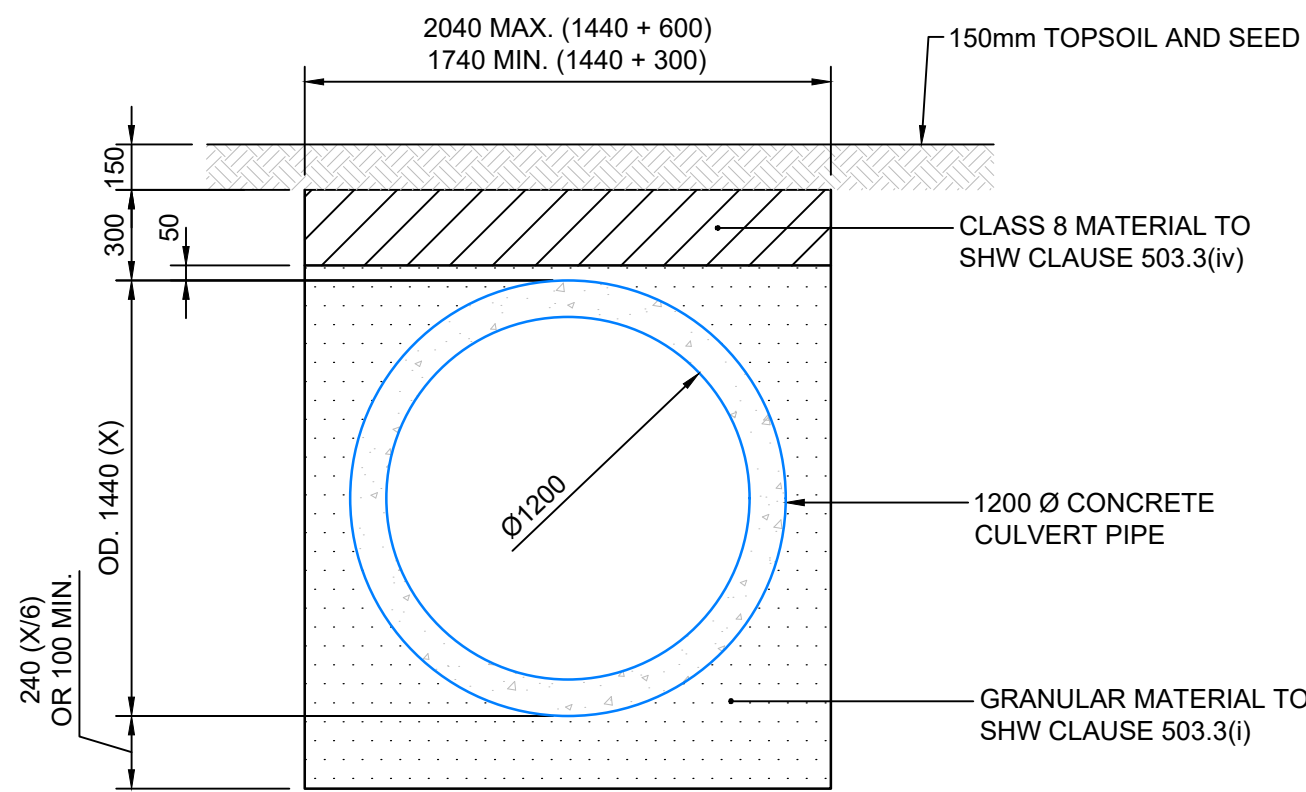

TYPE 'S' PIPE BEDDING DETAIL
SOFT LANDSCAPED AREAS

(TO HCD DETAILS)
1:25

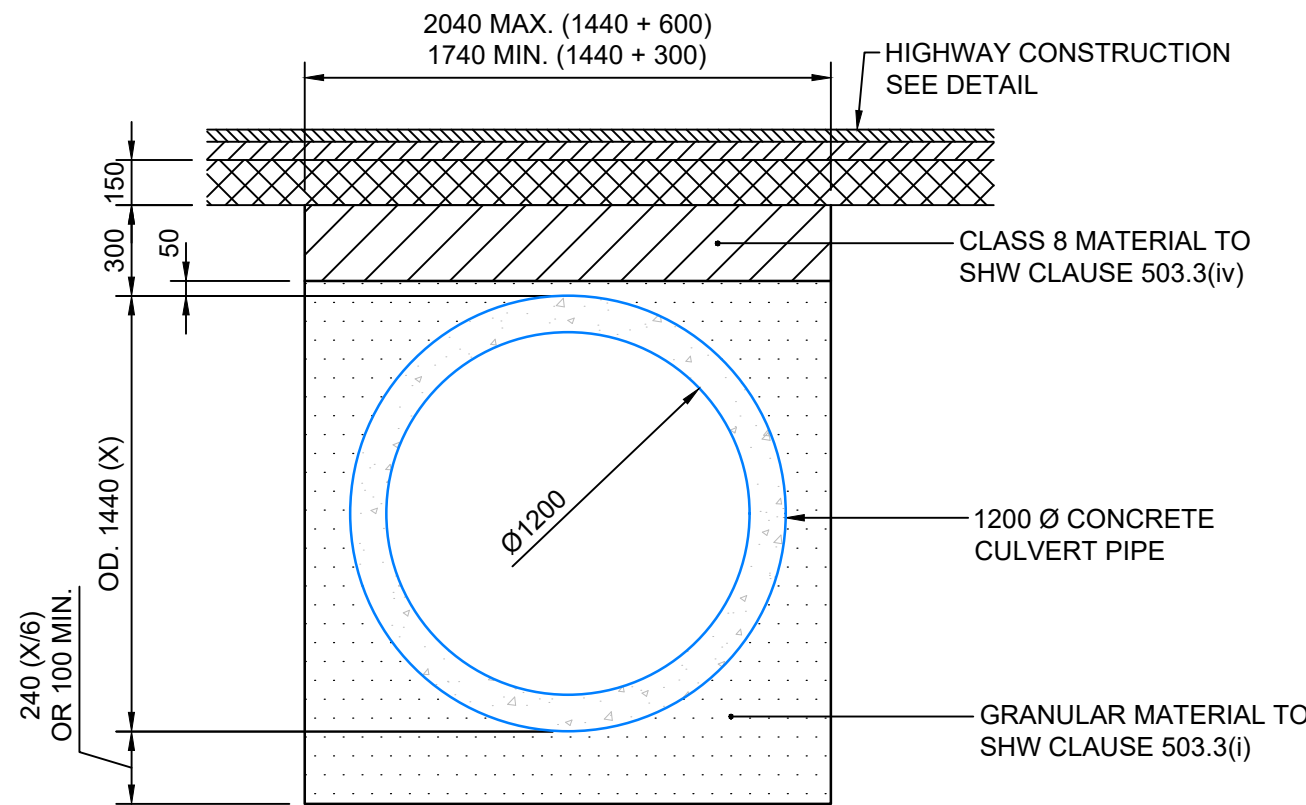

TYPE 'S' PIPE BEDDING DETAIL
HIGHWAY CONSTRUCTION AREAS

(TO HCD DETAILS)
1:25

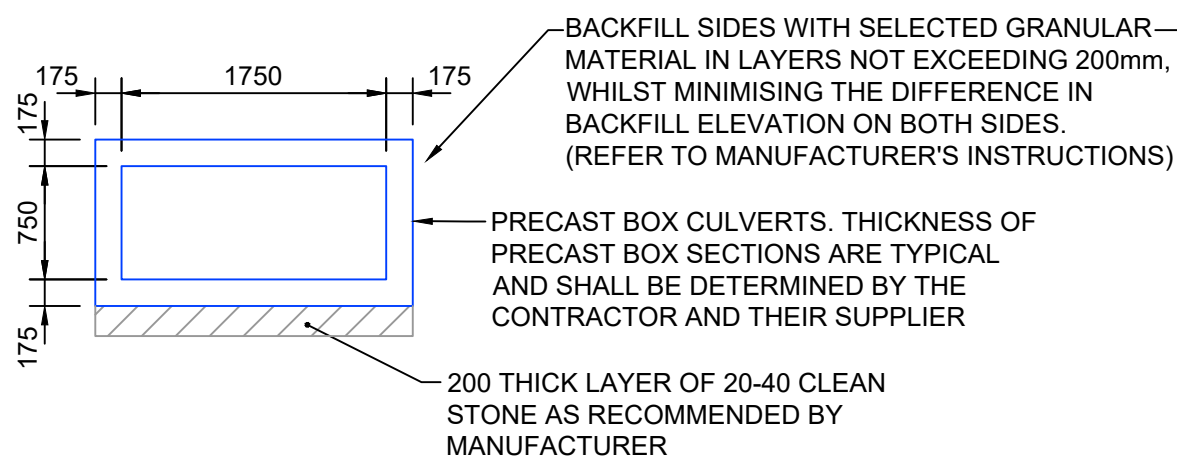

TYPICAL CULVERT DETAIL

1:50

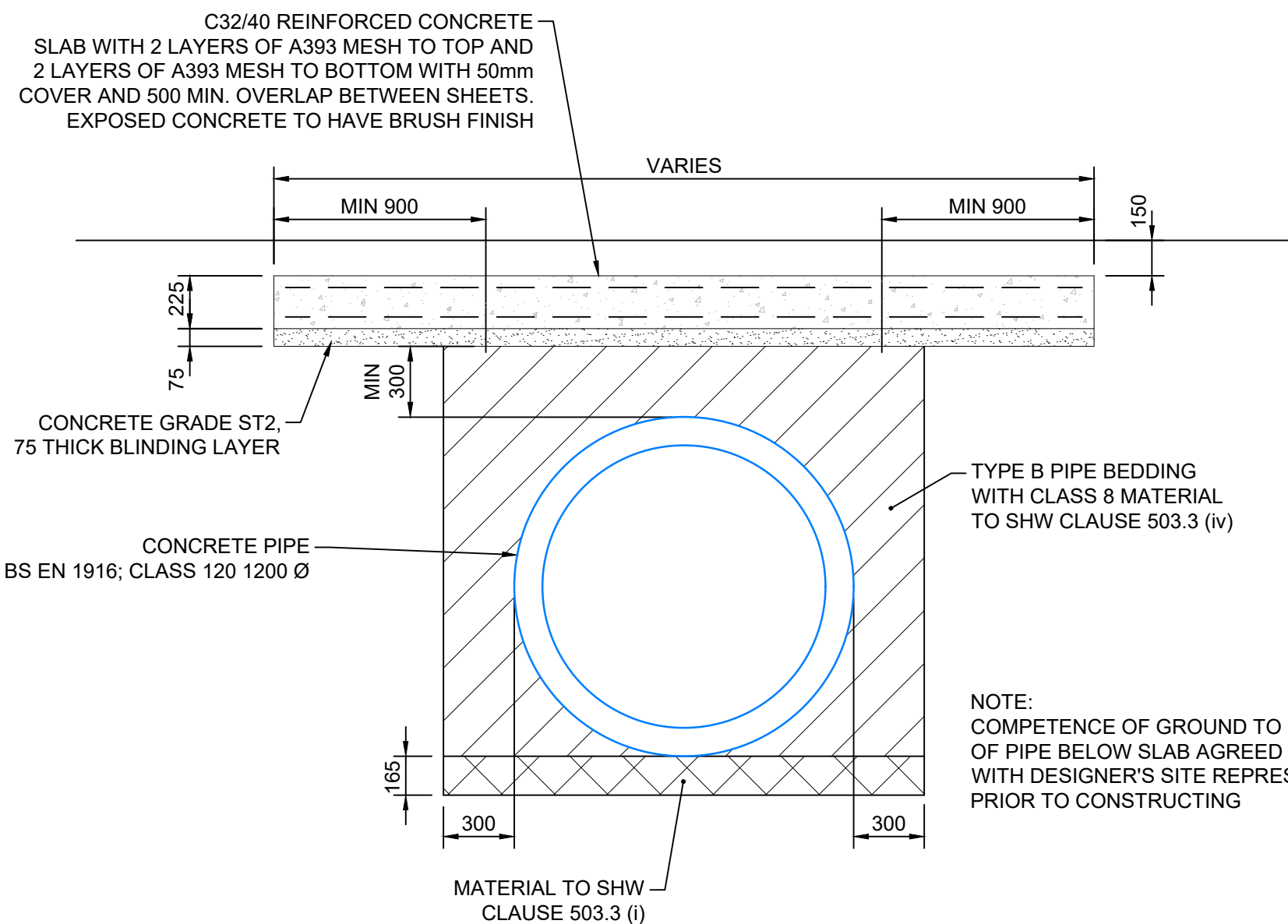

TYPICAL CONCRETE SURFACING REINSTATEMENT DETAIL

SCALE 1:25

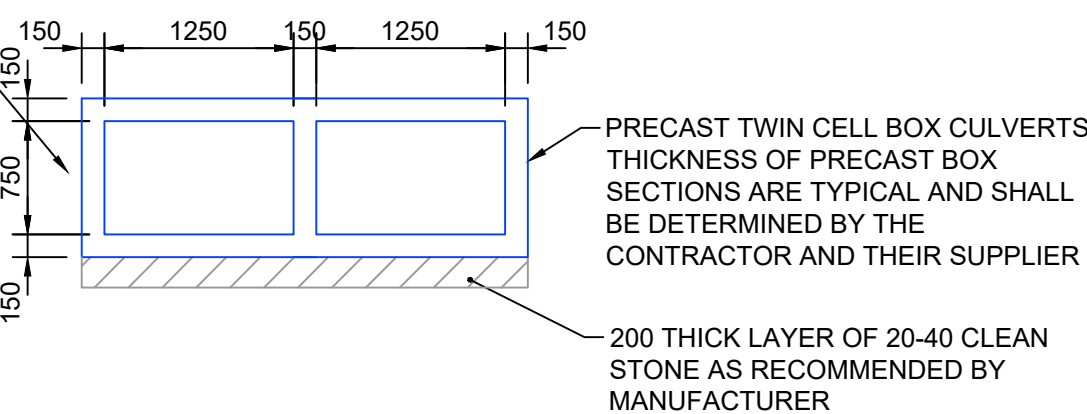

TYPICAL TWIN CELL CULVERT DETAIL

1:50

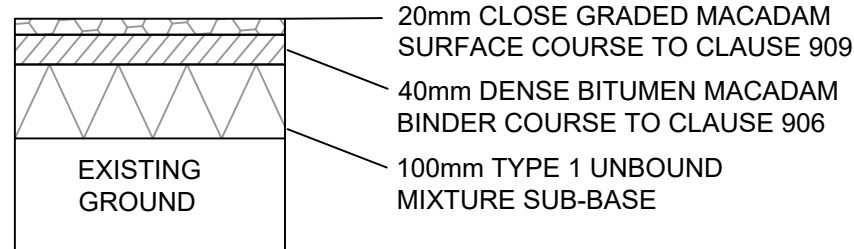

FOOTWAY CONSTRUCTION

SCALE 1:10

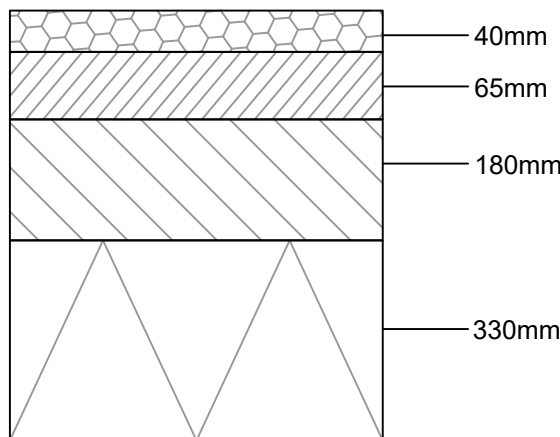

CARRIAGEWAY CONSTRUCTION

SCALE 1:10

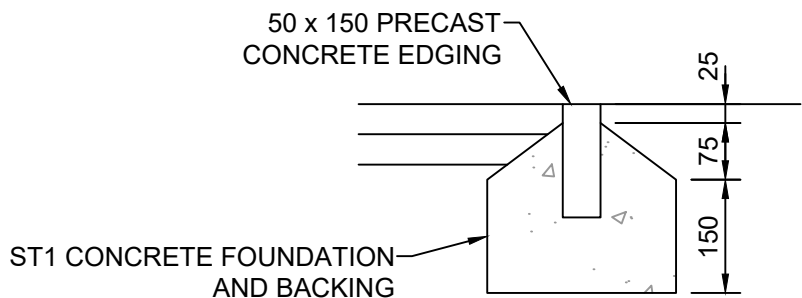

TYPICAL EDGING KERB DETAIL

SCALE 1:10

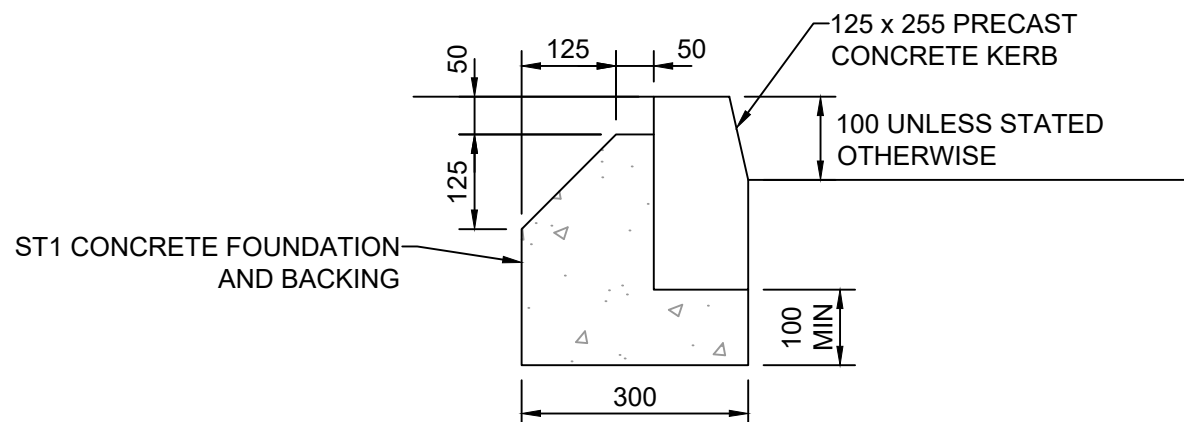

TYPICAL KERB DETAIL

SCALE 1:10

This map is reproduced from Ordnance Survey material with the permission of Ordnance Survey on behalf of the Controller of Her Majesty's Stationery Office © Crown copyright. Unauthorised reproduction infringes Crown copyright and may lead to prosecution or civil proceedings. (Neath Port Talbot Council) – 100023392 – 2019

NOTES

- ALL DIMENSIONS ARE IN MILLIMETRES UNLESS OTHERWISE NOTED.
- ALL LEVELS ARE IN METRES ABOVE ORDNANCE DATUM UNLESS OTHERWISE NOTED.

Description	Status	Revision	Drawn	Checked	Reviewed	Authorised	Issue Date
Description	Status	Revision	Drawn	Checked	Reviewed	Authorised	Issue Date
Description	Status	Revision	Drawn	Checked	Reviewed	Authorised	Issue Date
Description	Status	Revision	Drawn	Checked	Reviewed	Authorised	Issue Date
Description	Status	Revision	Drawn	Checked	Reviewed	Authorised	Issue Date
Description	Status	Revision	Drawn	Checked	Reviewed	Authorised	Issue Date
Description	Status	Revision	Drawn	Checked	Reviewed	Authorised	Issue Date
Description	Status	Revision	Drawn	Checked	Reviewed	Authorised	Issue Date

Drawing Suitability	Status
WORK IN PROGRESS	S0
 West Glamorgan House 12 Orchard Street Swansea West Glamorgan SA1 5AD Tel: +44 (0)1792 641172 Fax: +44 (0)1792 472019 www.atkinsglobal.com	
Client	NEATH PORT TALBOT COUNTY BOROUGH COUNCIL

SAFETY, HEALTH AND ENVIRONMENTAL INFORMATION			
In addition to the hazards/risks normally associated with the types of work detailed on this drawing, note the following significant residual risks (Reference shall also be made to the design hazard log).			
Construction <ul style="list-style-type: none">Requirement for services diversions in advance of works to install new culvertPotential for encountering unplotted services or private underground servicesaccess to be maintained to residential and commercial propertiesPresence of asbestos containing materials at Carreg HirPresence of contaminated soils in areas of former industrial use (land at Penrhiwin)Maintaining of existing surface water flowsSudden increase in flows			
Maintenance / Cleaning <ul style="list-style-type: none">Trash screen will require regular inspection and clearanceTrash screen and outfall to be inspected after storm eventsAttenuation tanks to be cleaned by high flow jettingSilt/rock traps to be emptied to prevent culvert blockage			
Use <ul style="list-style-type: none">Trash screen will require regular inspection and clearanceTrash screen and outfall to be inspected after storm eventsAttenuation tanks to be cleaned by high flow jettingSilt/rock traps to be emptied to prevent culvert blockage			
Decommissioning / Demolition <ul style="list-style-type: none">Requirement for services diversions in advance of works to install new culvertPotential for encountering unplotted services or private underground servicesaccess to be maintained to residential and commercial propertiesPresence of asbestos containing materials at Carreg HirPresence of contaminated soils in areas of former industrial use (land at Penrhiwin)Maintaining of existing surface water flowsSudden increase in flows			
Project Title GRANDISON BROOK			
Drawing Title TYPICAL DETAILS SHEET 1 OF 3			
Drawing Number Project NE05_001 Originator - ATK Volume - GEN Location SWMWREC Type - DR - CD Role - 000200 Number -			
Original Size: A1	Scale: AS SHOWN	Project Ref. No.: 5192793	Rev: P01.2