

DO NOT SCALE

100  
0 10  
Millimetres

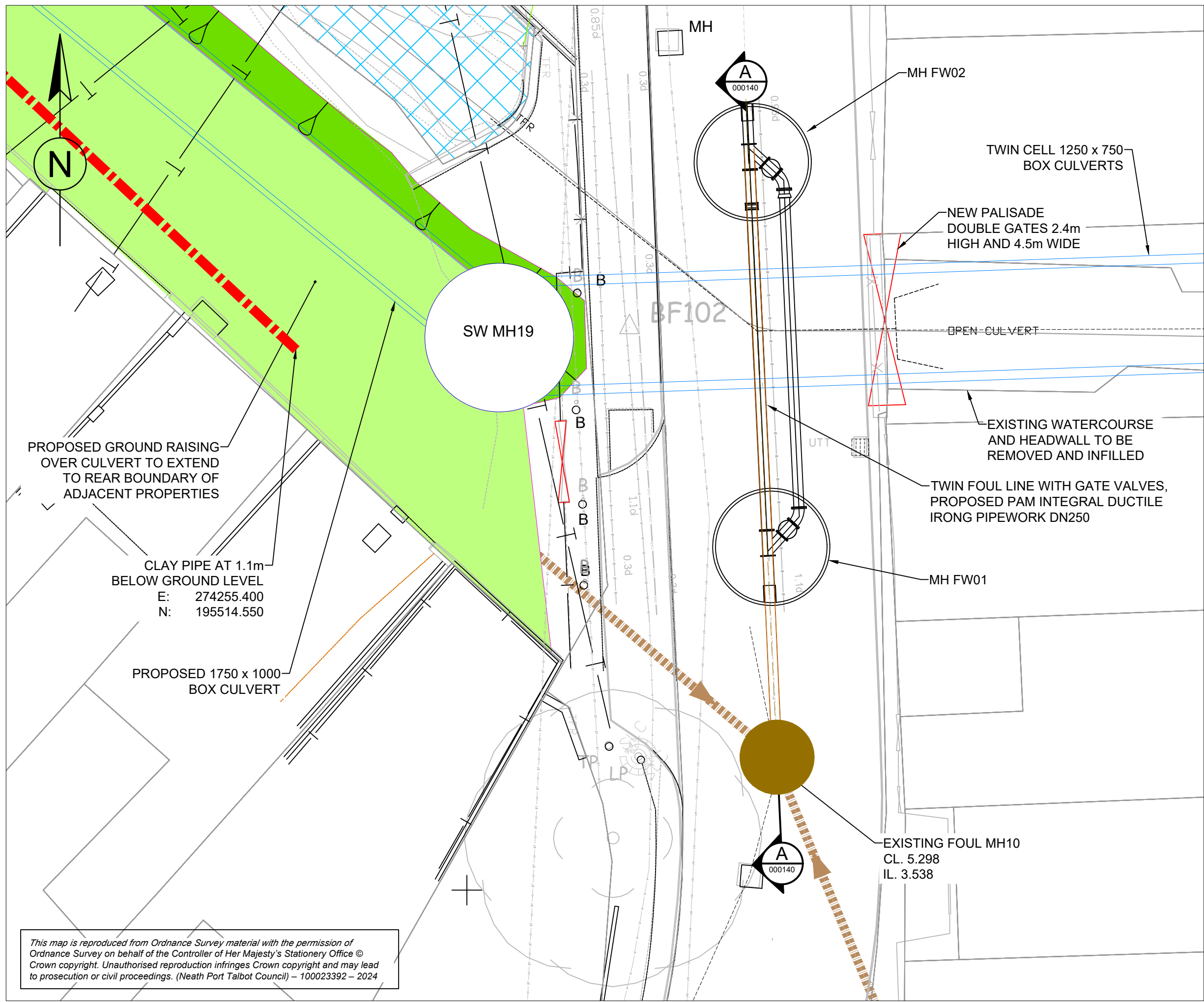

PLAN  
1:100

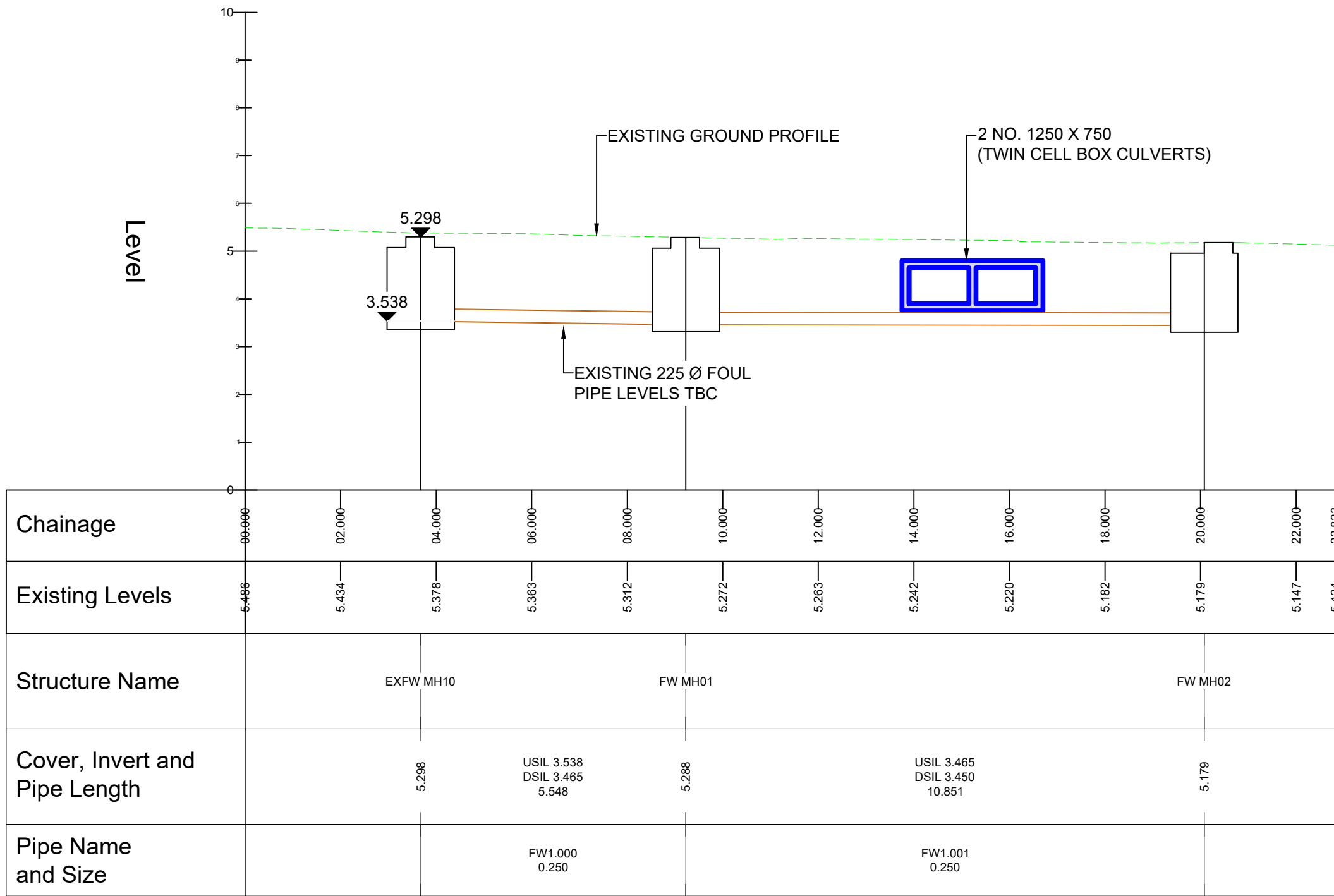

A  
000140  
1:100  
FOUL DRAINAGE LONG SECTION (EXFW MH10 - FW MH02)

Structure Schedule						
Structure Name	Cover Level	MH Depth	MH Size and Type	Connected Pipes	Easting	Northing
EXFW MH10	5.298	1.798	DMRB Type 3 Chamber	FW1.000 Inv. 3.538	274268.347	195503.576
FW MH01	5.288	1.823	1200 Dia. SFA Type B	FW1.001 Inv. 3.465 FW1.000 Inv. 3.465	274268.099	195509.118
FW MH02	5.179	1.729	1200 Dia. SFA Type B	FW1.001 Inv. 3.450	274267.596	195519.958

#### NOTES

- ALL DIMENSIONS ARE IN MILLIMETRES UNLESS OTHERWISE NOTED.
- ALL LEVELS ARE IN METRES ABOVE ORDNANCE DATUM UNLESS OTHERWISE NOTED.
- EXCAVATED MATERIAL TO BE DISPOSED OF AT CONTRACTOR'S LICENSED TIP.
- FOR MANHOLE NAD PIPE DETAILS OF PACKAGE PUMP STATION REFER TO DCWW DRAWING SMD4001/002.

#### SERVICES LEGEND

----- Neath Port Talbot Borough Council - Drainage	----- GTC
--- Neath Port Talbot Borough Council - Gully	--- Western Power Distribution
● Neath Port Talbot Borough Council - Street Light	--- Western Power Distribution - Overhead
--- Neath Port Talbot Borough Council - Street Lighting	--- Western Power Distribution - Substation
--- Neath Port Talbot Borough Council - Electric Street Furniture	--- Radar Trace
--- Dwr Cymru Welsh Water - Sewerage	--- Ysgol Carreg Hir Surface Water - Drainage
--- Dwr Cymru Welsh Water - Water	--- Ysgol Carreg Hir Surface Water - Filter Drain
--- Openreach - British Telecommunications	--- Ysgol Carreg Hir Foul Sewer
--- Openreach - British Telecommunications - Overhead	--- Network Rail asset
--- Virgin Media	
--- Vodafone	
--- Wales and West Utilities	

Description						
Status	Revision	Drawn	Checked	Reviewed	Authorised	Issue Date
Description						
Status	Revision	Drawn	Checked	Reviewed	Authorised	Issue Date
Description						
Status	Revision	Drawn	Checked	Reviewed	Authorised	Issue Date
Description						
Status	Revision	Drawn	Checked	Reviewed	Authorised	Issue Date
S0	P01.3	AJ	---	---	---	07/04/25

Drawing Suitability		Status
WORK IN PROGRESS		S0
 Member of the SNC-Lavalin Group Copyright © SNC Lavalin (2019) www.atkinsglobal.com		
Client  NEATH PORT TALBOT COUNTY BOROUGH COUNCIL		

SAFETY, HEALTH AND ENVIRONMENTAL INFORMATION			
In addition to the hazards/risks normally associated with the types of work detailed on this drawing, note the following significant residual risks (Reference shall also be made to the design hazard log).			
<b>Construction</b> <ul style="list-style-type: none"><li>Requirement for services diversions in advance of works to install new culvert</li><li>Potential for encountering unplotted services or private underground services</li><li>access to be maintained to residential and commercial properties</li><li>Presence of asbestos containing materials at Carreg Hir</li><li>Presence of contaminated soils in areas of former industrial use (land at Penhiwlin)</li><li>Maintaining of existing surface water flows</li><li>Sudden increase in flows</li></ul>			
<b>Maintenance / Cleaning</b> <ul style="list-style-type: none"><li>Trash screen will require regular inspection and clearance</li><li>Trash screen and outfall to be inspected after storm events</li><li>Attenuation tanks to be cleaned by high flow jetting</li><li>Silt/rock traps to be emptied to prevent culvert blockage</li></ul>			
<b>Use</b> <ul style="list-style-type: none"><li>Trash screen will require regular inspection and clearance</li><li>Trash screen and outfall to be inspected after storm events</li><li>Attenuation tanks to be cleaned by high flow jetting</li><li>Silt/rock traps to be emptied to prevent culvert blockage</li></ul>			
<b>Decommissioning / Demolition</b> <ul style="list-style-type: none"><li>Requirement for services diversions in advance of works to install new culvert</li><li>Potential for encountering unplotted services or private underground services</li><li>access to be maintained to residential and commercial properties</li><li>Presence of asbestos containing materials at Carreg Hir</li><li>Presence of contaminated soils in areas of former industrial use (land at Penhiwlin)</li><li>Maintaining of existing surface water flows</li><li>Sudden increase in flows</li></ul>			
Project Title <b>GRANDISON BROOK</b>			
Drawing Title <b>BROOK COURT DCWW FOUL SEWER DIVERSION GENERAL ARRANGEMENT</b>			
Drawing Number Project <b>NE05_001 - ATK - GEN - SWMWREC - DR - CD - 000140</b>			
Location Original Size: <b>A1</b> Scale: <b>AS SHOWN</b> Project Ref. No.: <b>5192793</b> Sheet: <b>1 of 1</b> Rev: <b>P01.3</b>			