

DO NOT SCALE

Millimetres

0

10

100

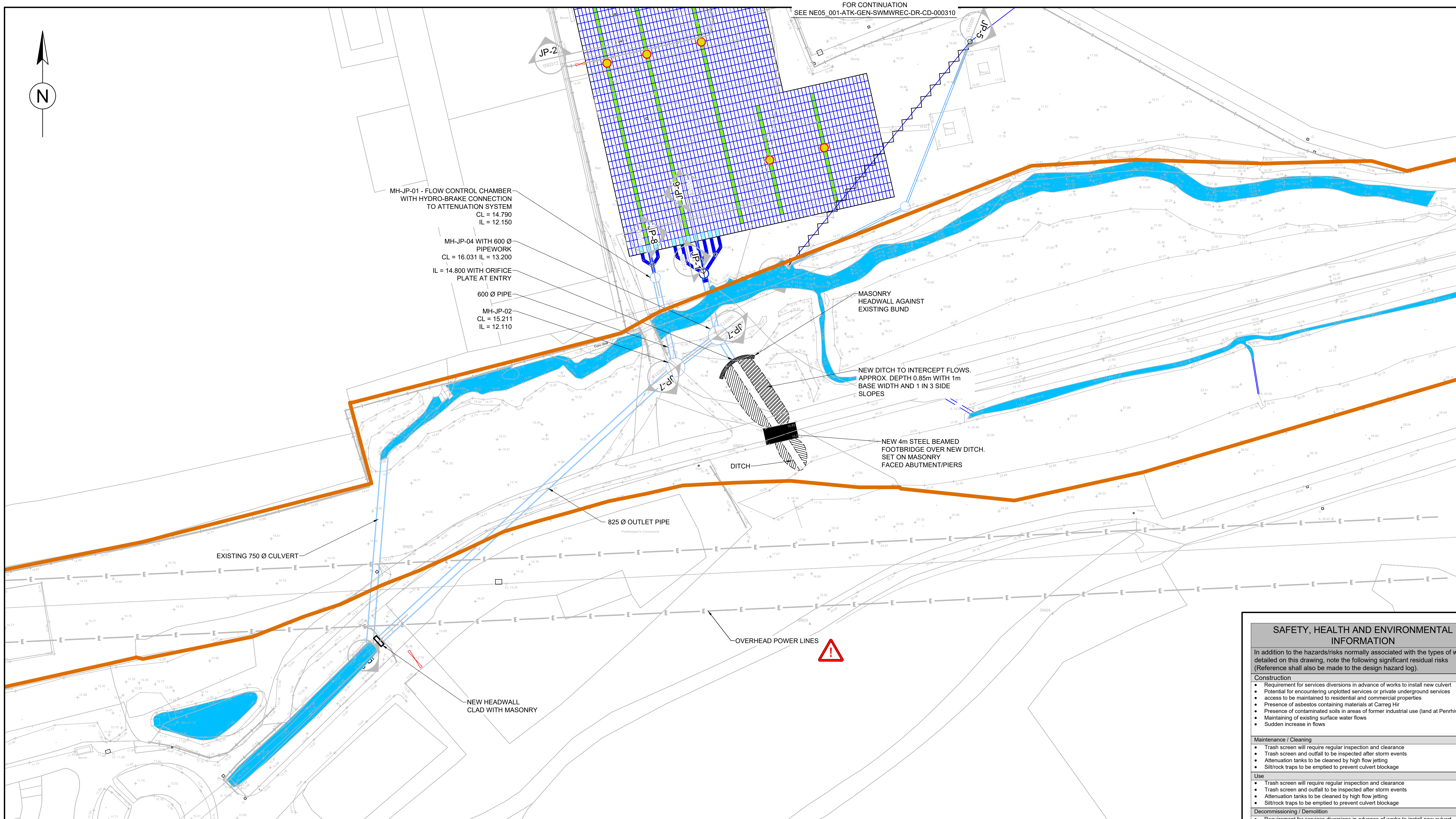

This map is reproduced from Ordnance Survey material with the permission of Ordnance Survey on behalf of the Controller of Her Majesty's Stationery Office © Crown copyright. Unauthorised reproduction infringes Crown copyright and may lead to prosecution or civil proceedings. (Neath Port Talbot Council) – 100023392 – 2019

PLAN
1:250

NOTES

1. ALL DIMENSIONS ARE IN MILLIMETRES UNLESS OTHERWISE NOTED.
2. ALL LEVELS ARE IN METRES ABOVE ORDNANCE DATUM UNLESS OTHERWISE NOTED.

Description	Status	Revision	Drawn	Checked	Reviewed	Authorised	Issue Date
Description	Status	Revision	Drawn	Checked	Reviewed	Authorised	Issue Date
Description	Status	Revision	Drawn	Checked	Reviewed	Authorised	Issue Date
Description	Status	Revision	Drawn	Checked	Reviewed	Authorised	Issue Date
Description	Status	Revision	Drawn	Checked	Reviewed	Authorised	Issue Date
Description	Status	Revision	Drawn	Checked	Reviewed	Authorised	Issue Date
Description	Status	Revision	Drawn	Checked	Reviewed	Authorised	Issue Date
Description	Status	Revision	Drawn	Checked	Reviewed	Authorised	Issue Date

Drawing Suitability	Status
WORK IN PROGRESS	S0
 Member of the SNC-Lavalin Group Copyright © SNC Lavalin (2019)	West Glamorgan House 12 Orchard Street Swansea West Glamorgan SA1 5AD Tel: +44 (0)1792 641172 Fax: +44 (0)1792 472019 www.atkinsglobal.com
 NEATH PORT TALBOT COUNTY BOROUGH COUNCIL	

SAFETY, HEALTH AND ENVIRONMENTAL INFORMATION
In addition to the hazards/risks normally associated with the types of work detailed on this drawing, note the following significant residual risks (Reference shall also be made to the design hazard log).
Construction <ul style="list-style-type: none">• Requirement for services diversions in advance of works to install new culvert• Potential for encountering unplotted services or private underground services• access to be maintained to residential and commercial properties• Presence of asbestos containing materials at Carreg Hir• Presence of contaminated soils in areas of former industrial use (land at Penhiwin)• Maintaining of existing surface water flows• Sudden increase in flows
Maintenance / Cleaning <ul style="list-style-type: none">• Trash screen will require regular inspection and clearance• Trash screen and outfall to be inspected after storm events• Attenuation tanks to be cleaned by high flow jetting• Silt/rock traps to be emptied to prevent culvert blockage
Use <ul style="list-style-type: none">• Trash screen will require regular inspection and clearance• Trash screen and outfall to be inspected after storm events• Attenuation tanks to be cleaned by high flow jetting• Silt/rock traps to be emptied to prevent culvert blockage
Decommissioning / Demolition <ul style="list-style-type: none">• Requirement for services diversions in advance of works to install new culvert• Potential for encountering unplotted services or private underground services• access to be maintained to residential and commercial properties• Presence of asbestos containing materials at Carreg Hir• Presence of contaminated soils in areas of former industrial use (land at Penhiwin)• Maintaining of existing surface water flows• Sudden increase in flows

Project Title	GRANDISON BROOK
Drawing Title	JERSEY PARK BELOW GROUND ATTENUATION SHEET 2 OF 2
Drawing Number	NE05_001
Project	ATK - GEN - SWMMWREC - DR - CD - 000311
Location	
Original Size	A1
Scale	
Project Ref. No.	5192793
Sheet	of
Rev	P01.3